

**Output power:** max. 200 Watt  
**DC current:** max. 10 A (at 20 V)  
**DC voltage:** max. 40 V (at 2A)

**Typical applications:** Water treatment  
 Electroplating Anodizing  
 Surface treatments Testing systems

DC power supply with linear regulated technology, designed for use in electroplating and/or for installation in a cabinet.



POWER STATION pe4606-LIN, front view

### Characteristic values

Linear regulation, digital controlled (DSP)

Constant current or voltage control

Regulation range for current and voltage: 1.5 % to 100 %

Linearity inaccuracy:

- for amperage < 0.3 %
- for voltage < 0.3 %

Ripple less than < 0.3 %

Duty cycle: 100 % at max. power

Soft start function

Permanent short-circuit proof

Installation altitude: max. 1000 m above sea level

Mains supply: 230 V/1; +/- 10 % 50-60 Hz, pluggable  
 (other voltages on request)

### Cooling

Air cooled

Sealed cooling air duct, the electronic components are not in direct contact with the cooling air stream

Air consumption: max. 50m<sup>3</sup>/h (automatic fan control)

Cooling air inlet in connecting side (turned air flow on request)

Ambient temperature 5 - 40 °C (other on request)

Over-temperature protected

Max. relative air humidity: 85 %, non-condensing

### Diaplays

Status LED, blink codes



POWER STATION pe4606-LIN, connection side

Possible output values (others on request)

Values	DC outputs										
	10 A		5 A		3 A		2 A		1 A		2 A
DC output current	10 A		5 A		3 A		2 A		1 A		2 A
DC output voltage	10 V	20 V	5 V,	6 V,	10 V,	12 V,	15 V,	20 V,	25 V,	30 V	40 V

### Standard dimensions

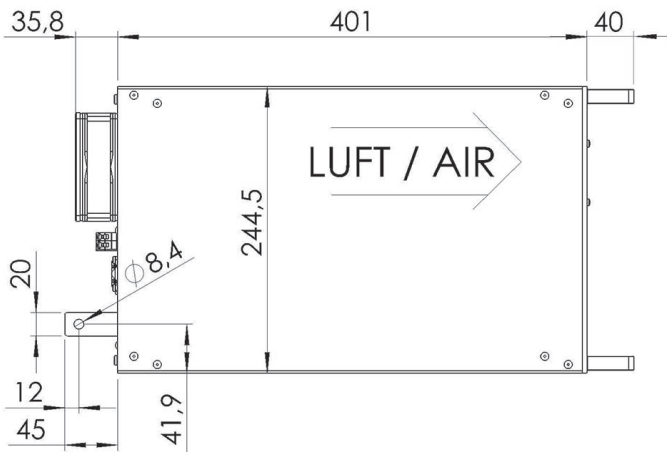

### Interface

#### peRB-interface

The used data telegram is pre-defined by plating electronic and can only be used in combination with:

- external control unit
- Bus adapter units for common external bus control systems
- Converter peRB-to-analog signals

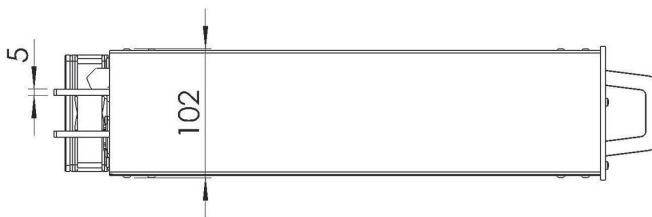

### Design

Stainless steel casing uncoated (powder-coating on request)

Anodized aluminium front panel (others on request)

Protecting grade: IP20

Weight: approx. 7.5 kg

Dimensions: see drawings

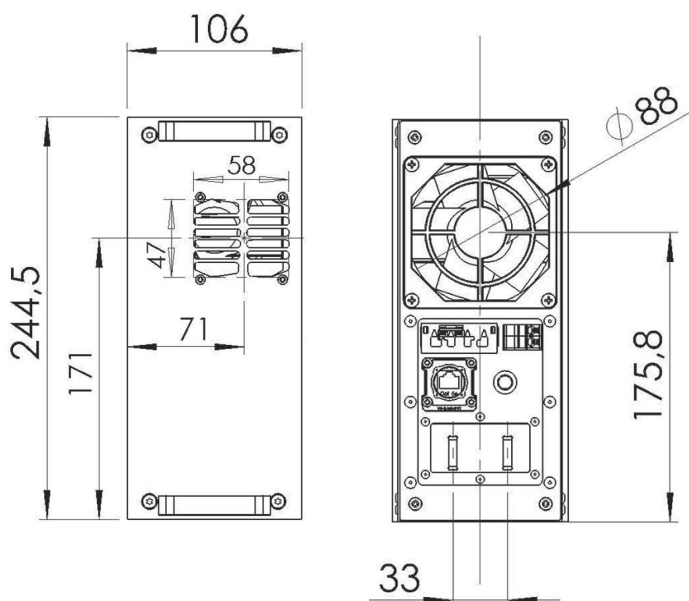

### DC connector

Tin-coated copper bars

Size, location and design of the DC output bus bars may differ from the standard

Technical equipment, design and features: subject to change! For further information please contact plating electronic GmbH.

plating electronic GmbH | 79350 Sexau | Fon +49 7641 93500-0 | www.plating.de  
Rheinstr. 4 | Germany | Fax +49 7641 93500-999 | info@plating.de